

Multilayer Metal Power Inductors MCOIL™ LLCN series

for Medical Devices classified as GHTF Classes A or B (Japan Classes I or II)

Code in front of Series have been extracted from Part number, which describes the segment of products, such as kinds and characteristics.

REFLOW

PART NUMBER

* Operating Temp.: -40~+125°C(Including self-generated heat)

L	L	C	N	A	2	0	1	2	H	K	T	1	R	0	M	
①	②	③	④	⑤	⑥	⑦	⑧									

①Series

Code (1)(2)(3)(4)	
LLCN	Multilayer metal power inductor for Medical Devices classified as GHTF Classes A or B (Japan Classes I or II)

(1) Product Group

Code	
L	Inductors

(3) Type

Code	
C	Metal Multilayer

(2) Category

Code	Recommended equipment	Quality Grade
L	Medical Devices classified as GHTF Classes A or B (Japan Classes I or II)	3

(4) Features, Characteristics

Code	
N	Standard Power choke

②Features

Code	Feature
A	L-shape electrode
B	L-shape electrode with polarity marking
D	Bottom electrode with polarity marking
E	5-surface electrode

⑤Packaging

Code	Packaging
T	Taping

③Dimensions (L × W)

Code	Type (inch)	Dimensions (L × W) [mm]
1005	1005(0402)	1.0 × 0.5
1210	1210(0504)	1.25 × 1.05
1412	1412(0505)	1.4 × 1.2
1608	1608(0603)	1.6 × 0.8
2012	2012(0805)	2.0 × 1.25
2016	2016(0806)	2.0 × 1.6

⑥Nominal inductance

Code (example)	Nominal inductance [μH]
R24	0.24
R47	0.47
1R0	1.0

※R=Decimal point

⑦Inductance tolerance

Code	Inductance tolerance
M	±20%

⑧Internal code

④Thickness

Code	Thickness [mm]
EK	0.50 max
EE	0.55 max
FK	0.60 max
FE	0.65 max
HK	0.80 max
KK	1.0 max

STANDARD EXTERNAL DIMENSIONS / STANDARD QUANTITY

L-shape electrode

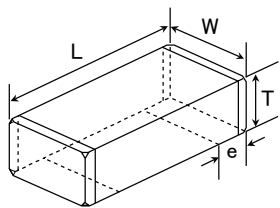

L-shape electrode with polarity marking

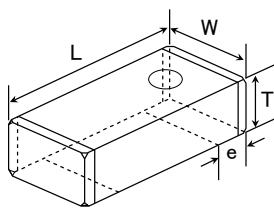
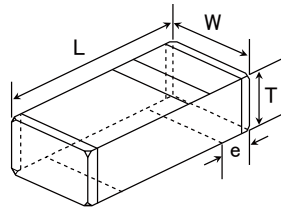

5-surface electrode

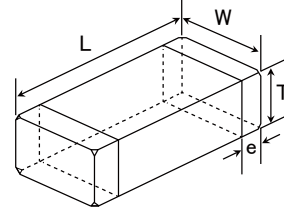

Bottom electrode with polarity marking

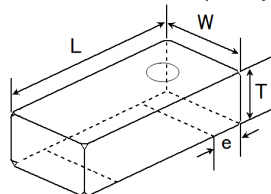

Type	L	W	T	e	Standard quantity [pcs]	
					Paper tape	Embossed tape
1005EE (0402)	1.0±0.2 (0.039±0.008)	0.5±0.2 (0.020±0.008)	0.55 max (0.022 max)	0.25±0.15 (0.010±0.006)	10000	—
1210EK (0504)	1.25±0.1 (0.049±0.004)	1.05±0.1 (0.041±0.004)	0.50 max (0.020 max)	0.30±0.2 (0.012±0.008)	5000	—
1412FE (0505)	1.4±0.2 (0.055±0.008)	1.2±0.2 (0.047±0.008)	0.65 max (0.026 max)	0.50±0.2 (0.02±0.008)	4000	—
1608FK (0603)	1.6±0.2 (0.063±0.008)	0.8±0.2 (0.031±0.008)	0.60 max (0.024 max)	0.3±0.2 (0.012±0.008)	4000	—
1608FE (0603)	1.6±0.2 (0.063±0.008)	0.8±0.2 (0.031±0.008)	0.65 max (0.026 max)	0.3±0.2 (0.012±0.008)	4000	—
1608HK (0603)	1.6±0.2 (0.063±0.008)	0.8±0.2 (0.031±0.008)	0.80 max (0.031 max)	0.4±0.2 (0.016±0.008)	4000	—
1608KK (0603)	1.6±0.2 (0.063±0.008)	0.8±0.2 (0.031±0.008)	1.0 max (0.039 max)	0.3±0.2 (0.012±0.008)	—	3000
2012HK (0805)	2.0±0.2 (0.079±0.008)	1.25±0.2 (0.049±0.008)	0.80 max (0.031 max)	0.5±0.3 (0.02±0.012)	4000	—
2012KK (0805)	2.0±0.2 (0.079±0.008)	1.25±0.2 (0.049±0.008)	1.0 max (0.039 max)	0.5±0.3 (0.02±0.012)	—	3000
2016FE (0806)	2.0±0.2 (0.079±0.008)	1.6±0.2 (0.063±0.008)	0.65 max (0.026 max)	0.5±0.3 (0.02±0.012)	4000	—

Unit: mm (inch)